



Passenger Cable Chain Installation and Removal Instructions



Shur Grip Z is one of the most popular winter traction products available today. Please read and follow the installation and usage tips shown here. A few moments spent familiarizing yourself with this product's features will yield many hours of safe and trouble-free winter driving.

- * Shur Grip Z traction products **exceeds S.A.E. Class "S"** requirements for vehicles with limited clearance. (Refer to your vehicle owner's manual)
- * This product is intended for use on snow and ice covered roads. As such, it is legal in every state and province in North America, including those where studded tires are prohibited.
- * Refer to page three of this booklet for important information regarding the use of this product.

A properly installed chain:

Important: We strongly recommend that the chains be fitted to the tire prior to actual use to insure proper fit. Tire sizes may vary because of age, manufacturer, tread or type. Please ensure that the following points are correct when installing your chains.

1. The cable chain should drape at least 2 inches over each side of the tire from the edge of the tread.
2. The round hook connector should be on the inside of the tire; The flat hook connector should be on the outside of the tire. The smooth portion of connectors and cross member hooks should be against tire. (Marked "TIRE SIDE".)
3. Rubber tensioners must be attached to take up additional slack in cable for a snug fit. Hooks on rubber tensioner should face away from tire.

Covered by one or more of the following patents: U.S. Patent Nos. 4,366,850; 5,056,574 and 5,299,613; Canadian Patent No. 1,170,154; Chinese Patent No. 15831; Japanese Patent No. 1,971,292 and Taiwanese Patent no. 53400. U.S. and foreign patents pending.

© SCC, Div of Burns Bros Inc., Clackamas, OR 97015-0949

All rights reserved; no part may be reproduced in any form or by any means without written permission.

SCC

Div. of Burns Bros. Inc.
P.O. Box 949
Clackamas, OR 97015-0949



CAUTION: CHAIN TIGHTENERS MUST BE USED

Installation



1 Park vehicle on firm level ground, away from traffic and turn off the engine. Set the emergency brake. Remove any wheel covers. Chains should be installed on drive tires. Lay the cable chain on the ground with the smooth side (TIRE SIDE) of the cross member hooks up.



2 Move the chain in a sweeping motion under the vehicle so the open mid-section is positioned against the backside of the tire. This sweeping motion can best be done while kneeling in front of the tire.



3 Reach around each side of the tire and grasp both ends of the non-split cable (the cable that is furthest away from you). Pull both ends to the top of the tire so the fasteners can be seen and manipulated more easily. Connect the inside fastener.



4 At the top of the outside cable, take the bushing end of the outside split side cable and thread it through the keyhole fastener. Grasp the outside cable with both hands and pull it toward you to create as much slack as possible.



5 Take the bushing end of the lower fastener and thread it through the keyhole (the one near the ground) using the same process as the top fastener. Please see below for a detailed look at making this connection.



6 Attach the rubber tensioner to take up the additional slack. To make this simpler, attach the first hook at the "12 o'clock" position, the next at the "6 o'clock" position and so forth. The open side of the hooks must face away from the tire. No further adjustment is necessary.

Removal

Drive vehicle off highway to safe level ground. Turn off the engine and set the parking brake. Remove the rubber tensioner from the side cable. Unhook the outside and inside fasteners. Lay the chain on the ground and drive off of it. Examine the chains for damage or worn parts. Dry off and spray with an all-purpose lubricant. Roll chains together and place back in package.

Close-up of outside fastening system

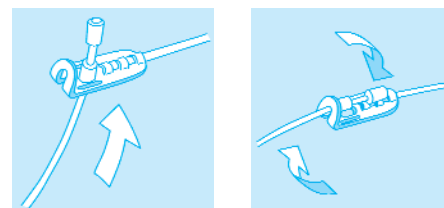

⚠ CAUTION: All winter traction products will wear out with extended use. They can also break due to misfit, misapplication or misuse. If this should occur, stop immediately and remove the chain. Care should be taken when using this product on wheels or wheel covers that protrude outward beyond the sidewall of the tire. Wheel covers should be removed to prevent possible markings made by rubber tensioners. On vehicles with protruding alloy wheels, other traction products that do not use a rubber tensioner (such as SCC's Z-Chain or ladder-style cable products) should be used. If these cautions are ignored, SCC and its distributors are not responsible for injury or vehicle damage.

Important:

- * We strongly recommend that the chains be fitted to the tire prior to actual use to insure proper fit. Tire sizes may vary because of age, manufacturer, tread or type.
- * Shur Grip Z meets SAE Class "S" clearance requirements (15.00mm). Once the chains have been installed, drive a short distance. If you hear any contact of the chain to any vehicle part, remove chains immediately.
- * Vehicle manufacturers' determine the clearance requirements based on the original (OEM) tires provided with the vehicle. Placing different size tires on your vehicle may affect the clearance necessary to operate this product.
- * Care should be taken when using this product on wheels or wheel covers that protrude outward beyond the sidewall of the tire. Wheel covers should be removed to prevent possible markings made by the rubber tensioner. On vehicles with protruding alloy wheels, other traction products that do not use a rubber tensioner (such as SCC's Z-Chain or ladder style cable products) should be used.
- * During installation of the chain, ensure that the chain drapes at least 2 inches over each side of the tire from the edge of the tread.
- * With traction devices installed, the vehicle will handle differently (for example, a longer braking distance on pavement without snow or ice). Adjust your driving to these changed conditions.
- * Shur Grip Z is intended for use on snow and ice-covered roads. As such, it is legal in every state and province in North America, including those where studded tires are prohibited. (Check local laws and regulations for any restrictions in your area.)

For maximum chain life:

- * Avoid speeds over 30 mph and use on bare pavement. Traction coils on cross members will fragment and cause cross members to break. Damage could occur to chains, tires and vehicles.
- * Insure rubber tensioners are used at all times.
- * Avoid spinning tires: start slowly, even in uphill conditions.
- * Avoid locking brakes: the best braking technique is a pumping action.
- * If a cross member should break, stop & remove or replace it immediately.
- * After use, clean and spray with an all-purpose lubricant.

One Year Limited Warranty

This product is warranted free from defect in workmanship and material for one year from the date of delivery to the user. Defective product may be returned to the manufacturer, freight prepaid, within 10 days of alleged defect. Inspection will be made to determine cause of failure. Chain determined to be defective will be repaired or replaced. Buyer shall not be entitled to recover any incidental or consequential damages. No compensation will be made for any labor claim, delays or damages incurred by using this product. Although this warranty gives you specific rights, you may have other legal rights which differ from state to state. For more information, please write to:

SCC
Customer Service Dept.
P.O. Box 949
Clackamas, OR 97015-0949



Speeds over 30 mph, improper fit or improper installation voids this warranty.